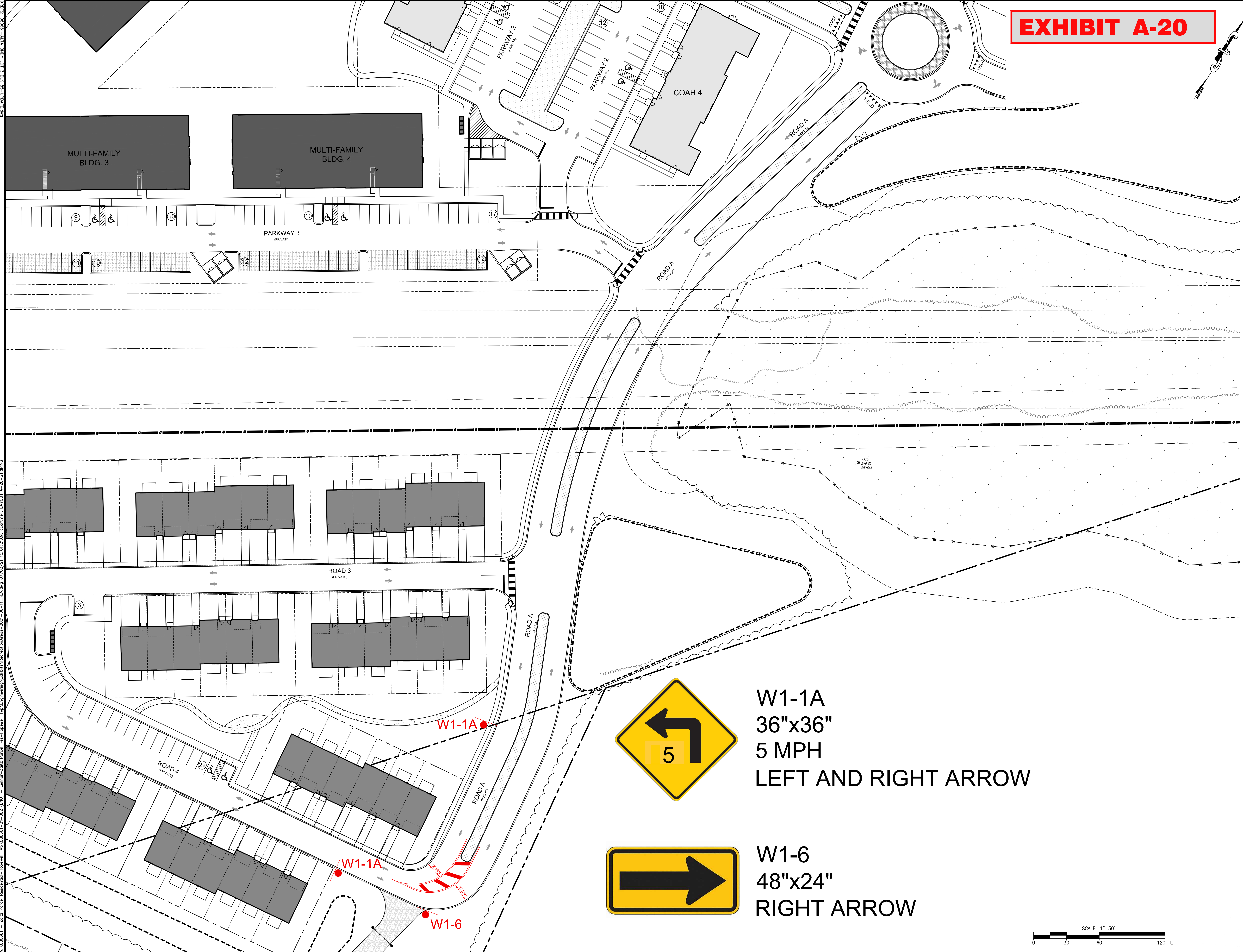
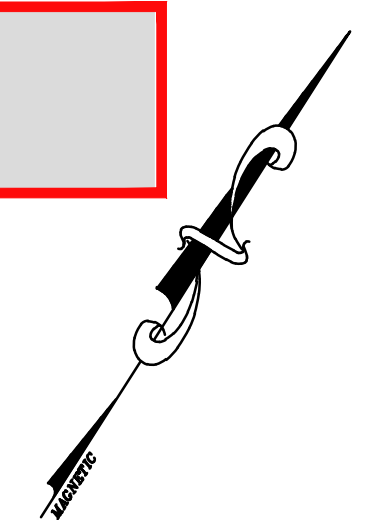

EXHIBIT A-20



W1-1A
36"x36"
5 MPH
LEFT AND RIGHT ARROW



W1-6
48"x24"
RIGHT ARROW

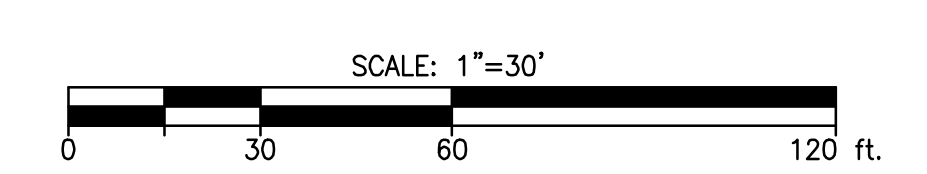

V:\080661 - Zaltz Parcel Residential-Hopewell_Twp\080661-01-002 (ENG) - Zaltz Parcel Res-Hopewell_Twp_Engineering\Exhibits\RecreationAreas-2021-06-11_REV.dwg 07/02/21 10:01:21AM, ccorimell, LAYOUT.A-20-STRIPING
 REVISIONS: 1 - 08/02/21 10:01:21AM, ccorimell, LAYOUT.A-20-STRIPING
 R - 08/02/21 10:01:21AM, ccorimell, LAYOUT.A-20-STRIPING
 P - 08/02/21 10:01:21AM, ccorimell, LAYOUT.A-20-STRIPING
 S - 08/02/21 10:01:21AM, ccorimell, LAYOUT.A-20-STRIPING
 E - 08/02/21 10:01:21AM, ccorimell, LAYOUT.A-20-STRIPING
 C - 08/02/21 10:01:21AM, ccorimell, LAYOUT.A-20-STRIPING
 A - 08/02/21 10:01:21AM, ccorimell, LAYOUT.A-20-STRIPING
 M - 08/02/21 10:01:21AM, ccorimell, LAYOUT.A-20-STRIPING
 D - 08/02/21 10:01:21AM, ccorimell, LAYOUT.A-20-STRIPING

<p>PROJ: 080661-PT-001 DATE: 11-2021 THIS DRAWING AND ALL INFORMATION CONTAINED HEREIN IS THE PROPERTY OF BOWMAN CONSULTING. IT IS TO BE USED ONLY FOR THE PROJECT AND SITE SPECIFICALLY IDENTIFIED AND SHALL NOT BE REPRODUCED, COPIED, OR TRANSMITTED IN ANY FORM OR BY ANY MEANS, ELECTRONIC OR MECHANICAL, INCLUDING PHOTOCOPYING, RECORDING, OR BY ANY INFORMATION STORAGE AND RETRIEVAL SYSTEM, WITHOUT THE WRITTEN PERMISSION OF BOWMAN CONSULTING.</p> <p>Bowman CONSULTING</p> <p>Phone: 732-665-6000 Fax: 732-665-6001 NJ Certificate of Authorization www.bowmanconsulting.com www.bowmanconsulting.com</p> <p>Sean A. Delany, N.J. Professional Engineer, Lic. 246E0447100</p>	<table border="1" style="width: 100%; border-collapse: collapse;"> <tr> <th>NO.</th> <th>REVISION</th> <th>DATE</th> <th>CHKD</th> </tr> <tr> <td> </td> <td> </td> <td> </td> <td> </td> </tr> <tr> <td> </td> <td> </td> <td> </td> <td> </td> </tr> <tr> <td> </td> <td> </td> <td> </td> <td> </td> </tr> <tr> <td> </td> <td> </td> <td> </td> <td> </td> </tr> <tr> <td> </td> <td> </td> <td> </td> <td> </td> </tr> <tr> <td> </td> <td> </td> <td> </td> <td> </td> </tr> <tr> <td> </td> <td> </td> <td> </td> <td> </td> </tr> <tr> <td> </td> <td> </td> <td> </td> <td> </td> </tr> <tr> <td> </td> <td> </td> <td> </td> <td> </td> </tr> </table>	NO.	REVISION	DATE	CHKD																																				
NO.	REVISION	DATE	CHKD																																						

PRELIMINARY & FINAL MAJOR SUBDIVISION AND PRELIMINARY & FINAL SITE PLAN
THE COLLECTION at HOPEWELL
TRAFFIC WARNING MEASURES W/
RECREATIONAL AREA EXHIBIT
BLOCK 66, LOT 3; BLOCK 66, LOTS 92-94 & 95; AND PART OF BLOCK 65, LOT 9
TOWNSHIP OF HOPEWELL, MERCER COUNTY, NEW JERSEY

SHEET No. **1** OF **1**