

**TOWNSHIP OF HOPEWELL
MERCER COUNTY, NEW JERSEY**

ORDINANCE NO. 08-1448

**AN ORDINANCE TO SUPPLEMENT CHAPTER XVII – LAND USE AND
DEVELOPMENT, ARTICLE XV "HISTORIC PRESERVATION"
OF THE REVISED GENERAL ORDINANCES OF THE TOWNSHIP OF HOPEWELL**

WHEREAS, the Hopewell Township Historic Preservation Commission was established to ensure the protection, enhancement and perpetuation of historic buildings, structures, sites, objects, improvements and districts within the Township; and

WHEREAS, the Village of Harbourton is comprised of a collection of well preserved eighteenth and nineteenth century buildings that demonstrate the past domestic, agrarian, commercial and religious life Hopewell Township, including families who have farmed the land to be included in the district for more than two centuries, the Orlando property which has been placed in farmland preservation, the Harbourton Baptist Church, the stone portion of the Harbourton Store which contains the gable-end date stone marked 1768 and the initials "JH" to commemorate the founder of the village, John Harbourt; and

WHEREAS, the rural landscape to the south and east of the Village of Harbourton remains largely undeveloped and in agricultural use; and

WHEREAS, the intersection of two regional roads of colonial origin, has served as the reason for the existence of this crossroads village, and facilitated the commerce and travel of Hunterdon and Mercer Counties from the mid eighteenth century to the present day; and

WHEREAS, the Historic Preservation Commission has determined that this is one of the best preserved crossroads villages in Hopewell Township, and the only crossroads village which can be seen in its historical landscape; and

WHEREAS, recognizing the historic significance of this crossroads village, the Hopewell Township Historic Preservation Commission has resolved that the Hopewell Township Register of Historic Places should include an historic district to be known as the "Harbourton Rural Historic District"; and

WHEREAS, any such designation must be made by the Township Committee.

NOW, THEREFORE, BE IT ORDAINED, by the Township Committee of the Township of Hopewell, in the County of Mercer, State of New Jersey, that Chapter XVII – Land Use and Development, Article XV – Historic Preservation, Section 244 – Designation of Historic Landmarks and Historic Districts of the Revised General Ordinances of the Township of Hopewell, be supplemented follows:

SECTION I.

17-244.5 Historic Districts Designated

a. Harbourton Rural Historic District

1. The "Harbourton Rural Historic District" shall be designated as an historic district within the Township of Hopewell.

2. The Harbourton Rural Historic District shall consist of those properties, or parts thereof, designated on the plan entitled "Harbourton Rural Historic District" as determined by the Hopewell Township Historic Commission, which plan shall amend the Hopewell Township Zoning Map.

SECTION II.

In the event that any portion of this Ordinance is found to be invalid for any reason by any Court of competent jurisdiction, such judgment shall be limited in its effect only to the portion of the Ordinance actually adjudged to be invalid, and the remaining portions of this Ordinance shall be deemed severable therefrom and shall not be affected.

SECTION III.

This ordinance shall take effect upon final passage and publication in accordance with the law.

Date Introduced: October 27, 2008
Dated Advertised: October 30, 2008
Date Adopted: November 24, 2008

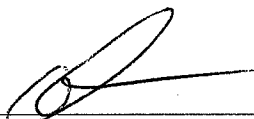

Vanessa Sandom
Mayor

Attest:

Annette C. Bielawski
Municipal Clerk

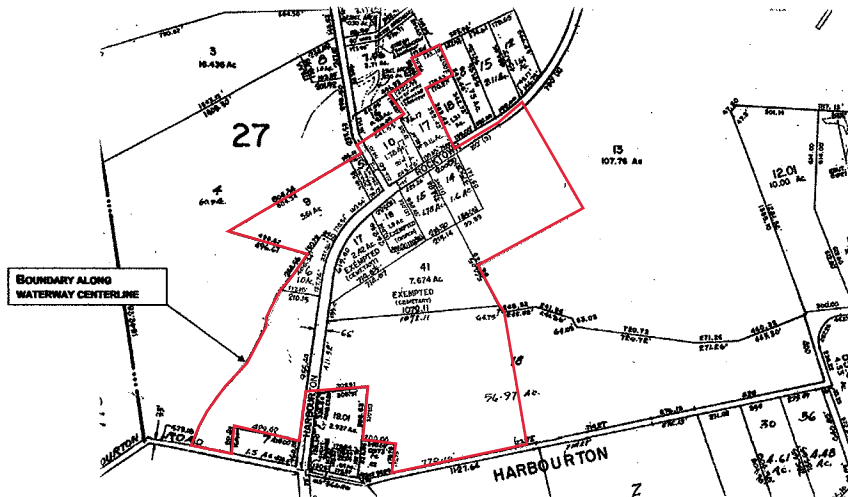

PROPOSED HARBURTON HISTORIC DISTRICT

- Includes the portion of Tax Lot 4 in Block 27 located between Harbourton-Rocktown Road and the existing waterway.
- Includes Tax Lots 5, 6 and 9 in Block 27; Tax Lots 10 and 17 in Block 28; and Tax Lots 14, 15, 16, 17 and 41 in Block 29 in their entirety.
- Includes the portion of Tax Lot 13 in Block 29 between the northerly boundary of Tax Lots 14 and 41 and the existing driveway serving Lot 13 from Harbourton-Rocktown Rd (575 feet +/-) and between Harbourton-Rocktown Rd and a line parallel with and measured 645 feet from Harbourton-Rocktown Rd.
- Includes a 14 acre portion of Tax Lot 18 in Block 29 bounded by Harbourton-Rocktown Rd and Harbourton-Woodsville Rd on the west and south and a new line on the east.